

JK 4 DOOR HALF ROOF RACK 2007-2018 JEEP WRANGLER



TOOLS REQUIRED

- 4mm Allen head
- 10mm wrenches
- Flat Head Screw Driver

SKILL LEVEL

- Novice/Intermediate
- 1 (you) to 2 persons

Little skill level required, you can easily assemble it by yourself however, additional help will be needed for install

TIME REQUIRED

- 2 Hours

Time to install this should only take about two hours

WARNINGS/CAUTIONS BEFORE STARTING INSTALLATION

Before you install this kit – Read and understand all instructions, warnings, cautions, and notes contained in this installation instruction guide. Consult your vehicle owner’s manual for proper disconnection of electrical and lifting of vehicle if required for installation of this product.

This install may require some technical skills and knowledge of basic mechanical work. If you do not feel that you are capable of performing this install please take this product to a trained professional.

After reading this guide please contact us with any questions or concerns before installing product.
Customer Service: 855-680-9595

DV8 Offroad is not responsible for any bodily injury or harm to you or your vehicle as a result of an improper install.

Proper installation of this kit required knowledge of the factory recommended procedures for removal and installation of original equipment components. We recommend that the factory shop manual and any special tools needed to service your vehicle be on hand during the installation. Installation of this kit without proper knowledge of the factory recommended procedures may affect the performance of these components and the safety of the vehicle

- Always wear eye protection when operating power tools

Inspect all contents of this package to make sure product is not damaged and all installation hardware has been included. If parts are missing from kit, please be prepared to provide the following information

1. Name of purchase location
2. Bar Code on side of box
3. Date above bar code
4. Date inside box cover



INSTALLATION MANUAL

STEP 1

Begin by unpacking all items and inspecting for missing pieces or damage. If you have any concerns, please contact the company the product was purchased from.

HARDWARE INCLUDED

- | | |
|----------------------|-----------------|
| (42) M6x14mm Bolts | (8) M6x20 Bolts |
| (80) M6 Flat Washers | (46) M6 Nuts |
| (58) M6 Split Washer | |
| (8) M6 Fender Washer | |
| (8) M6x25 Bolts | |



STEP 2

Lay out all cross bars and sides to prepare for assembly. Using a 10mm wrench and #4 allen head, assemble cross bars and sides with provided M6x14 hardware.

NOTE: The full length roof rack is pictured, however preparation and assembly of the rack is the same.

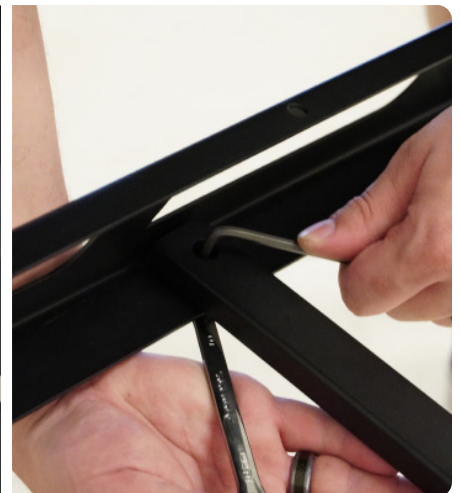

INSTALLATION MANUAL

STEP 3

Once roof rack is assembled, install side feet onto rack using a 10mm wrench and #4 allen head with M6x14 hardware.

NOTE: Do not tighten feet until rack is on Jeep to allow for adjustment.



STEP 4

Moving to the vehicle, with a flathead screw driver, pop off the rear window hinge covers.

NOTE: These can be brittle and break. Use extra caution when removing.



STEP 5

Using a 10mm socket, loosen the rear hinges from the hardtop. Do **not** remove the hinge and allow the glass to fall. These only need to be loosened by about 3/16".

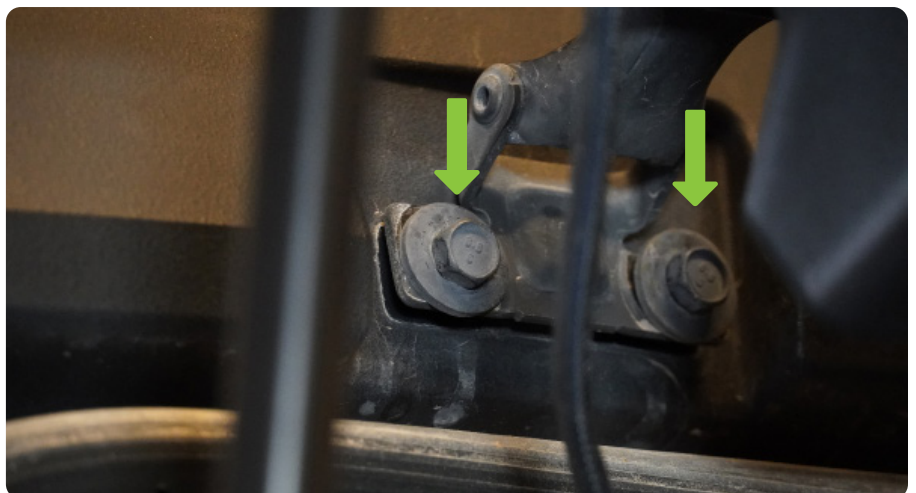

INSTALLATION MANUAL

STEP 6

Assemble the rear rack brackets as shown in the image. These will use the M6x20 hardware and will require the 10mm wrench and #4 allen head. Slide bracket between the factory hardtop and the rear window hinge and tighten until secure.



STEP 7

With additional help, lift the rack onto the vehicle and gently sent it down into place. Adjust feet so they land into the rain gutter. Ensure rack is pushed back towards the rear of the vehicle so the rack is resting against the rear hinge mount.



INSTALLATION MANUAL

STEP 8

Place the provided rubber trim on each foot and set back into rain gutter. Using the provided foam, place them on feet clamps as shown.

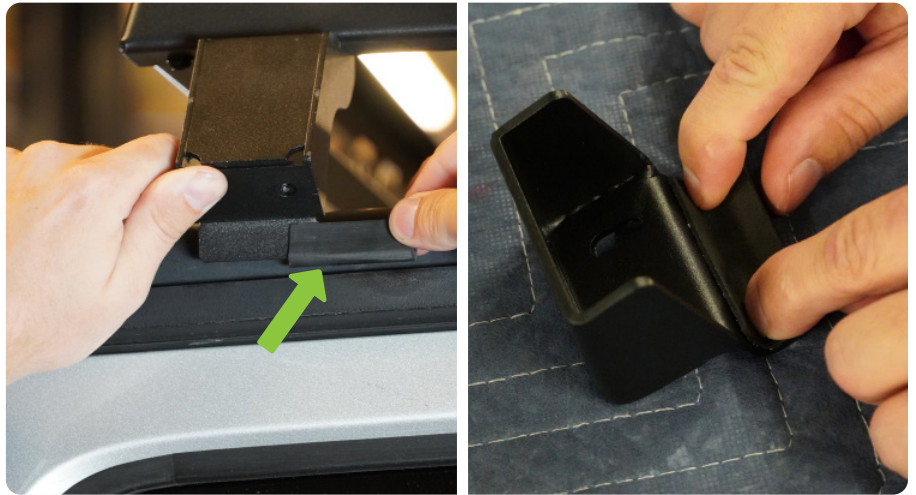

STEP 9

Install all the clamps onto each foot, and using a #4 allen and the M6x25 hardware. Leave loose for adjustment.



STEP 10

With the rack pressed up against the rear hinge brackets, using the remaining M6 hardware and the eight large shoulder M6 washers, loosely secure brackets to rack.



INSTALLATION MANUAL

STEP 11

For the tightening down process, using your #4 allen head, tighten the very front brackets first until the foot is seated into the rain gutter and the rack is secure.

NOTE: Do not over tighten since this can damage your hardtop.



STEP 12

Once the front feet are tight, push the rear of the rack down on the hinge brackets until the rack is level on the Jeep and has even spacing in the front and rear.



STEP 13

Tighten all clamps to the feet of the rack and double check rear bracket is secure.

Install the two rear hinge covers using M6x14 allen head screws.



INSTALLATION MANUAL

STEP 14

Tighten all feet to the rack. By doing this last, it will allow feet and rack to move as needed while securing all feet.

Reinstall factory plastic hinge caps. Double check fitment and that all hardware is secure.

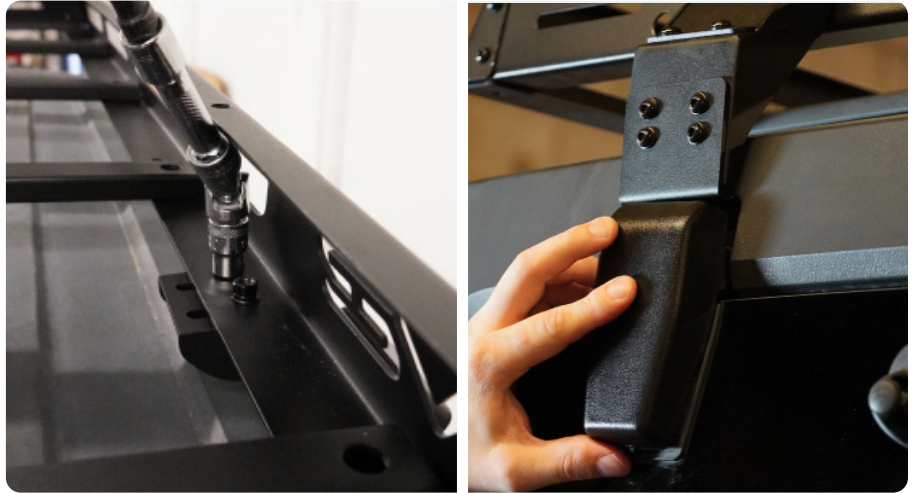

You are done with your install of the JK Half Length Roof Rack.

