

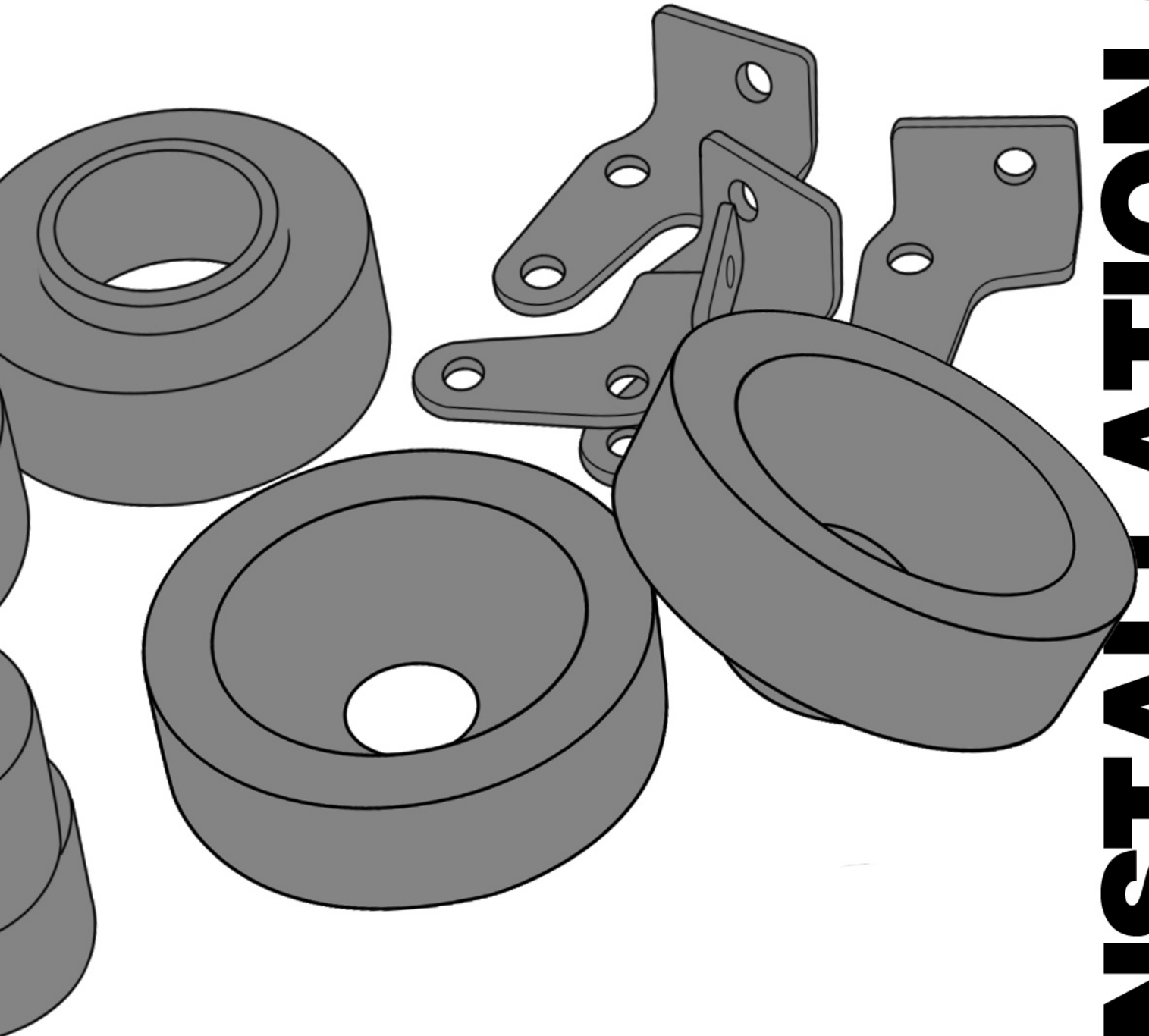

2.0" SPACER SUSPENSION SYSTEM



INSTALLATION GUIDE



PLEASE READ BEFORE YOU START

TO GUARANTEE A QUALITY INSTALLATION, WE RECOMMEND READING THESE INSTRUCTIONS THOROUGHLY BEFORE BEGINNING ANY WORK. THESE INSTRUCTIONS ASSUME A CERTAIN AMOUNT OF MECHANICAL ABILITY AND ARE NOT WRITTEN OR INTENDED FOR SOMEONE NOT FAMILIAR WITH AUTO REPAIR.

Included Parts

QTY

Required Tools

Front Spring Spacers	2	Common hand tools
Rear Spring Spacers	2	Jack Stands
Front Bumpstop Spacers	2	Floor Jack
Rear Bumpstop Spacers	2	
Shock Extension Brackets	4	
Front Stabalizer End-Links	2	
Hardware Pack	1	
Front Brake Line Drop Brackets	2	
Zip Ties	4	

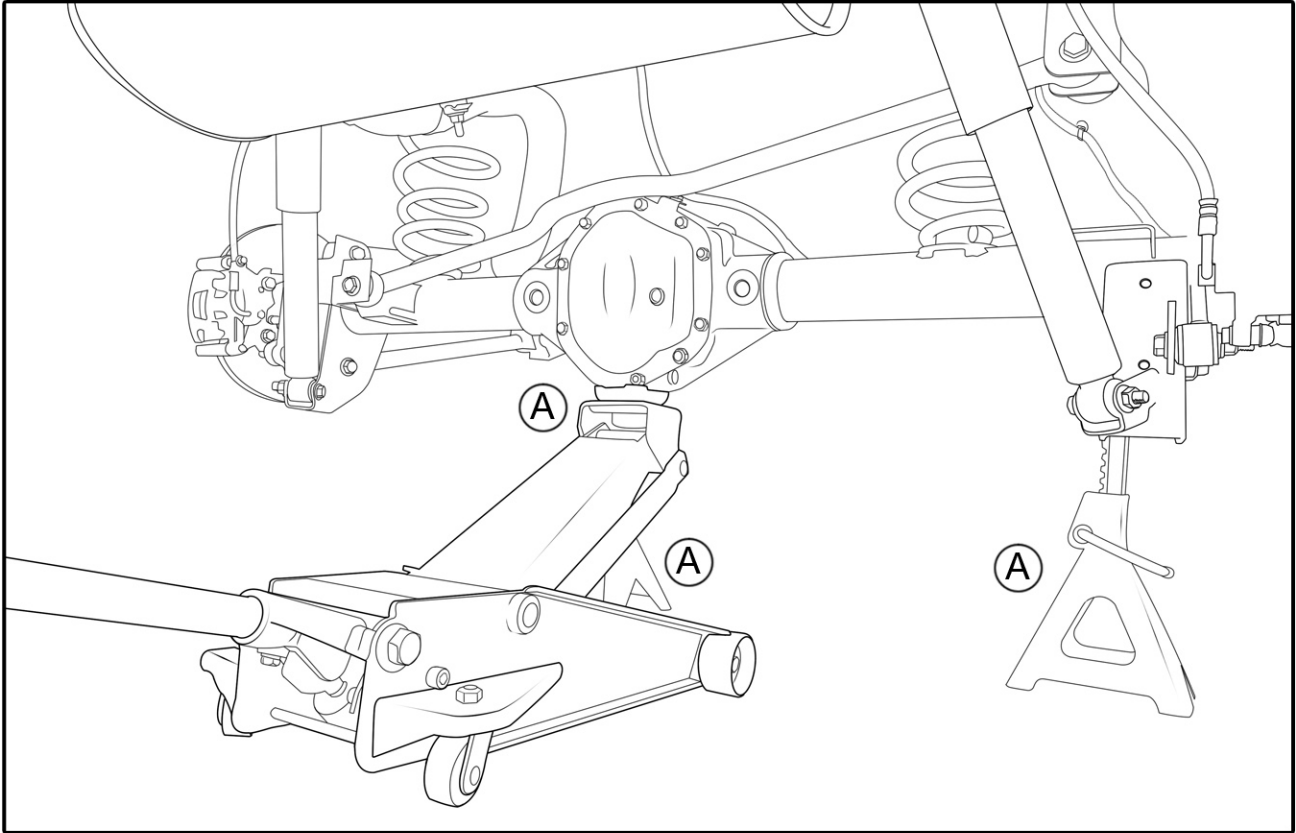

1. (A) Raise Jeep and support the frame using jack stands or a hoist such that the rear axle can be lowered enough to remove the springs. Support the axle by placing floor jack under the center of the axle. Remove the wheels.
(B) Loosen but DO NOT remove all 8 control arm bolts and both track bar bolts.

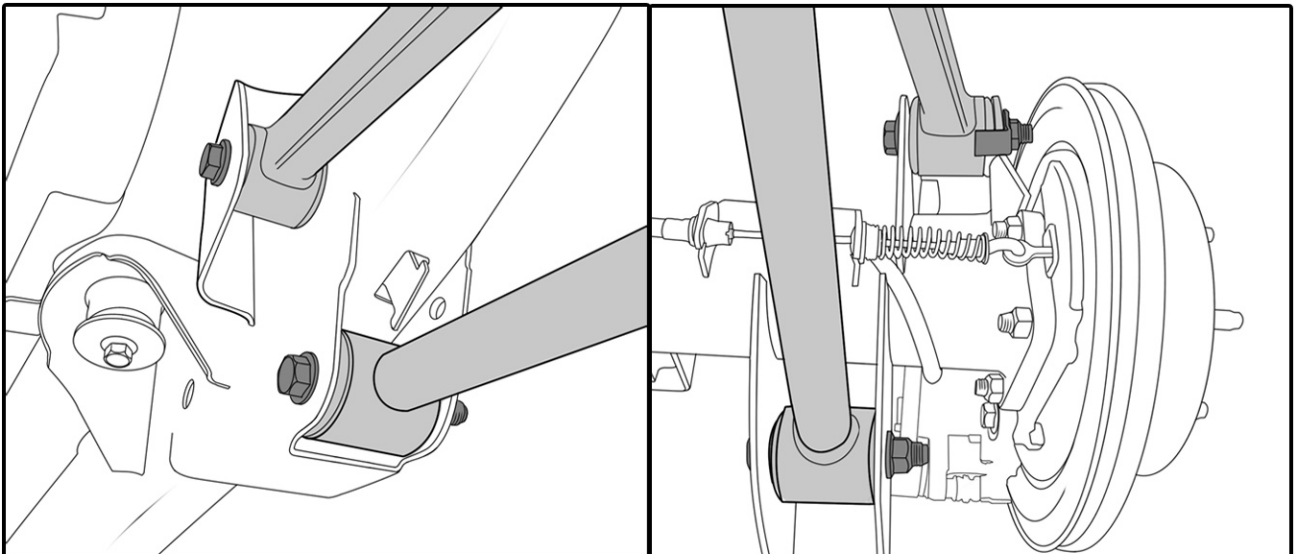

Images show only one side, be sure to complete both sides.

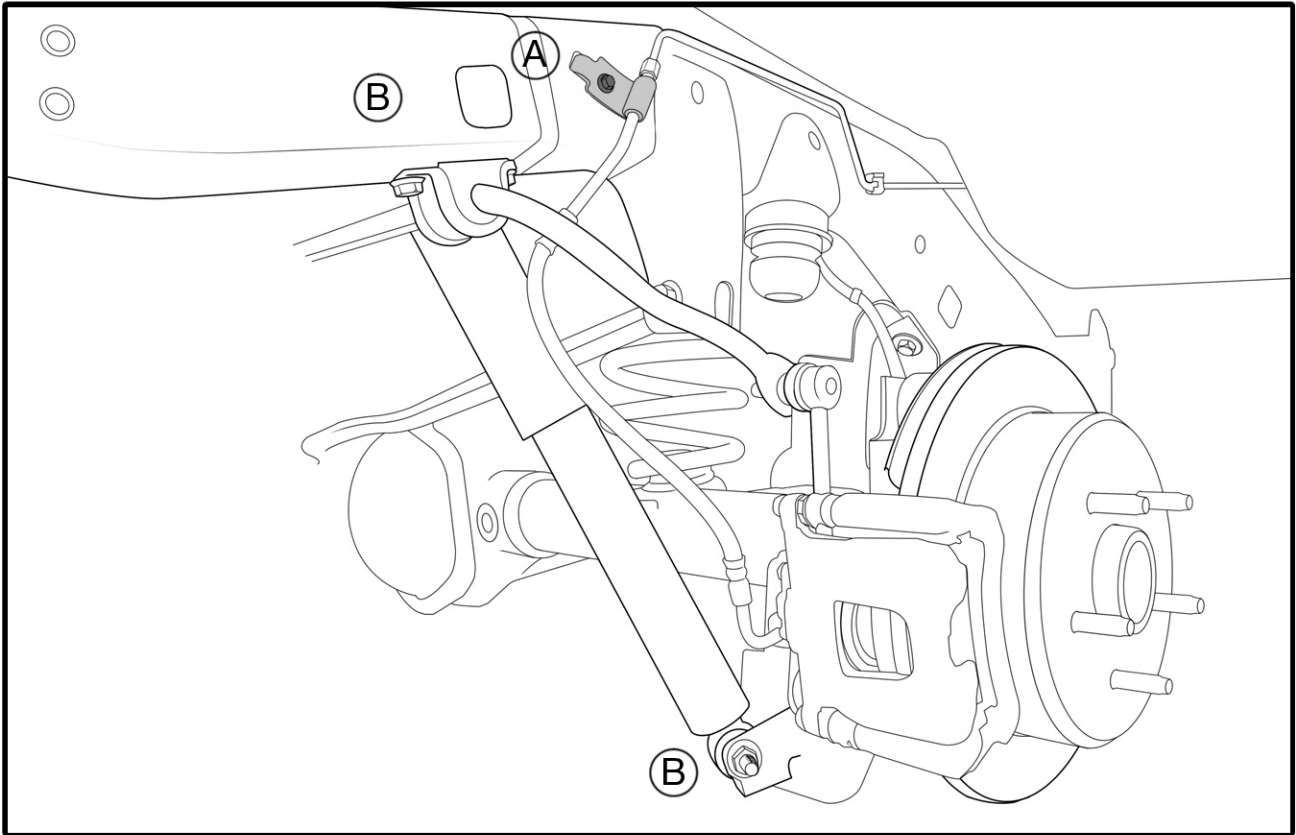

2. (A) Remove the bolts that hold the brake lines to the frame.
- (B) Remove the shocks.
- (C) Remove the lower bolt for each swaybar link.

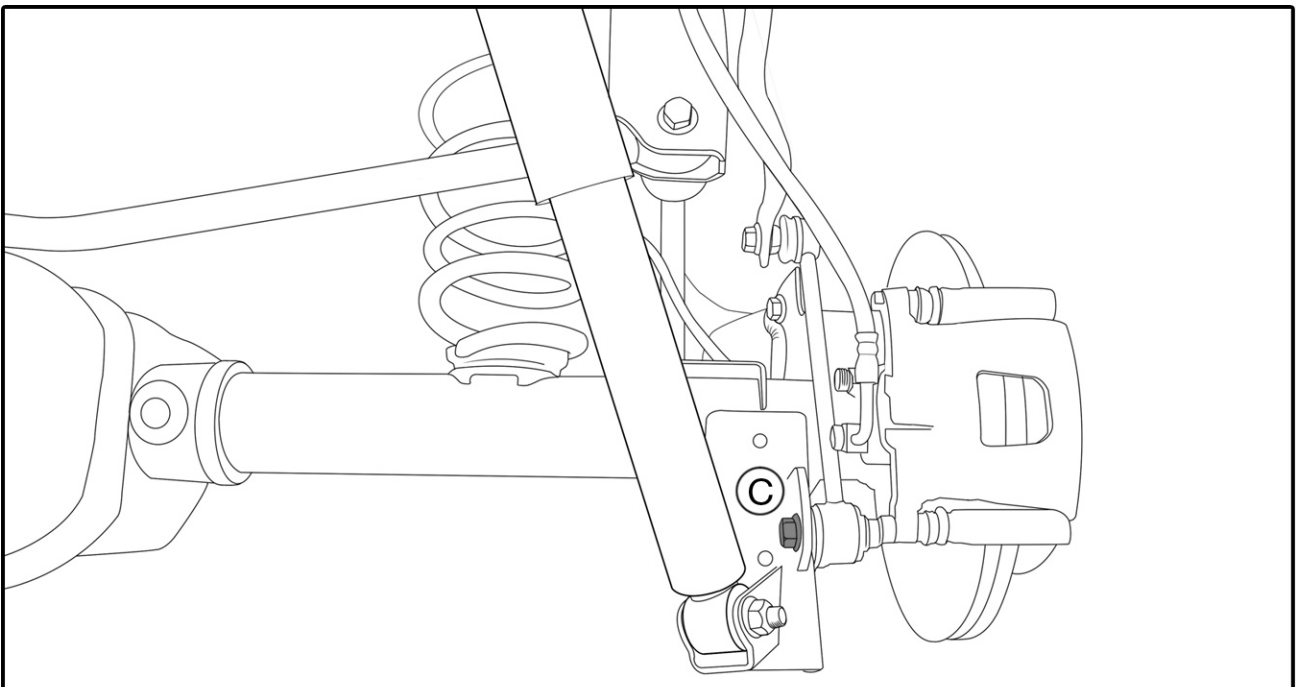

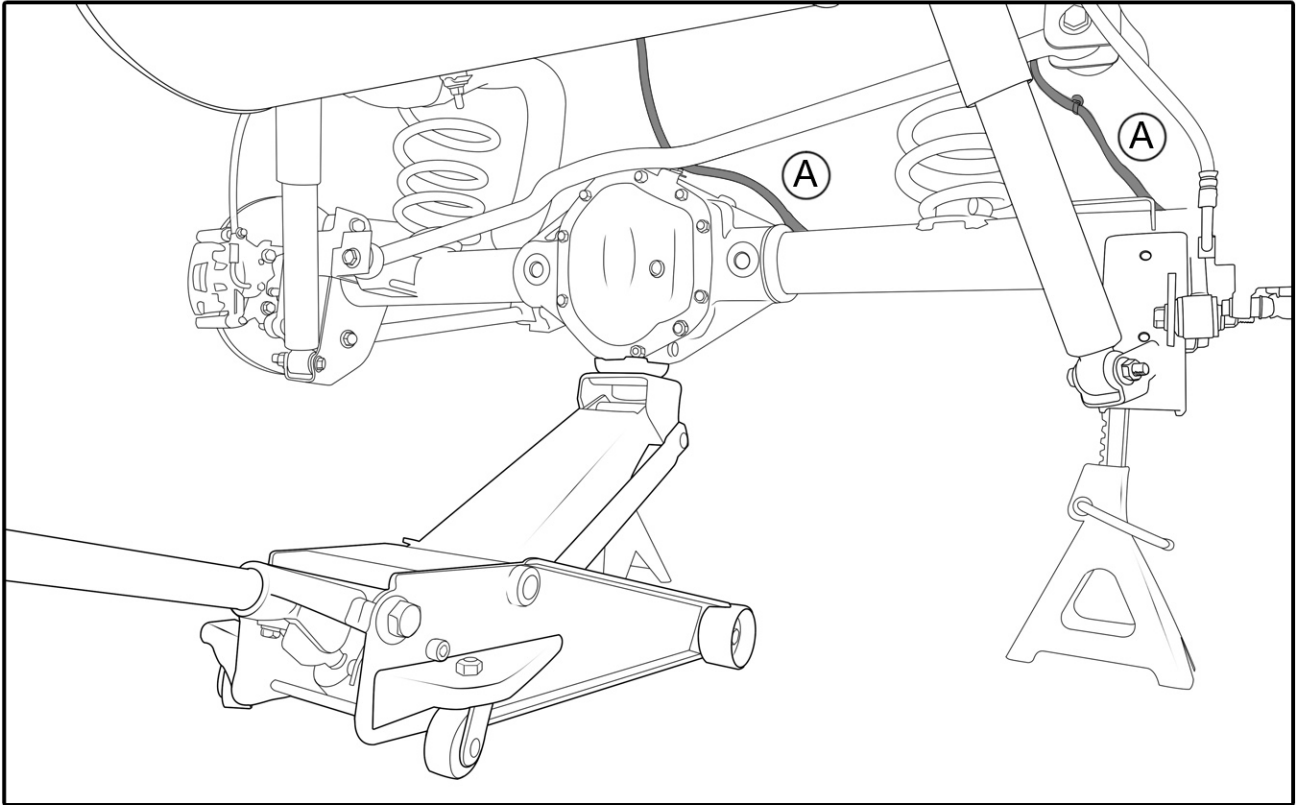

3. (A) Carefully lower the axle using the floor jack enough to remove the springs. DO NOT overextend the wheel speed sensor or locker wiring.
- (B) Remove the factory spring isolator located on top of the spring and discard. Replace with AEV Spring Spacer on top of factory springs making sure the top of the spring and spacer are properly located.

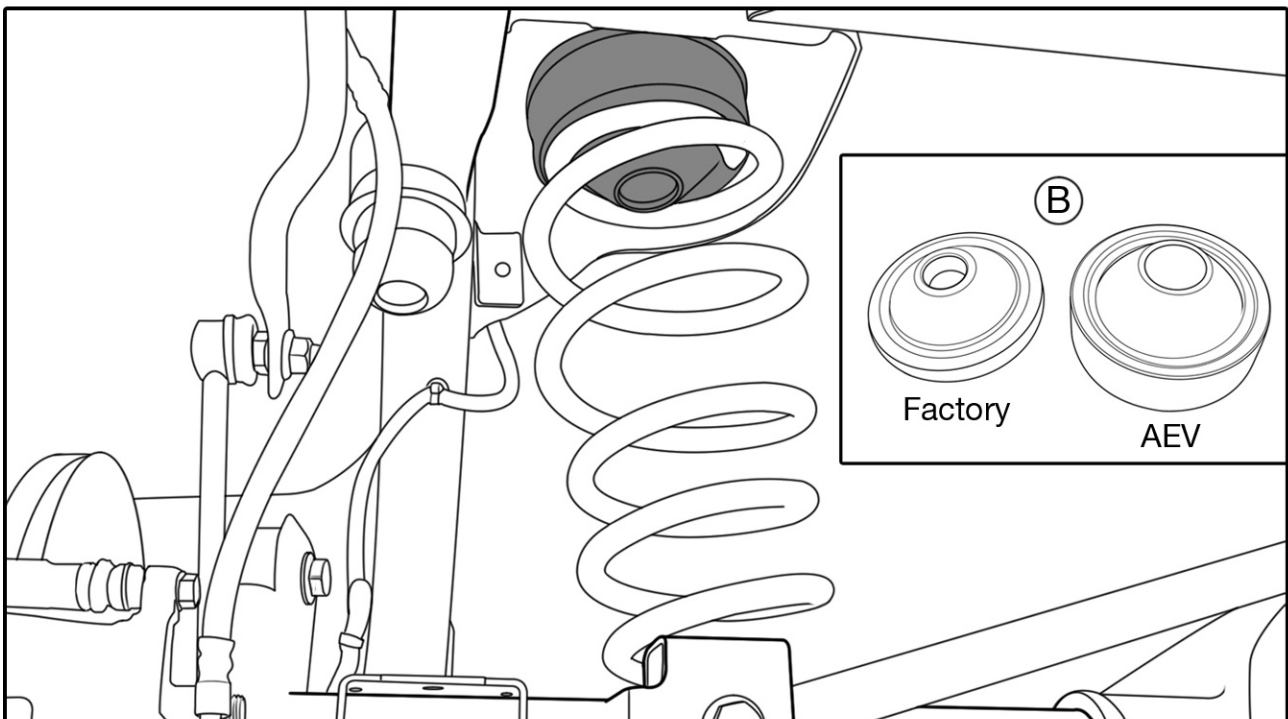

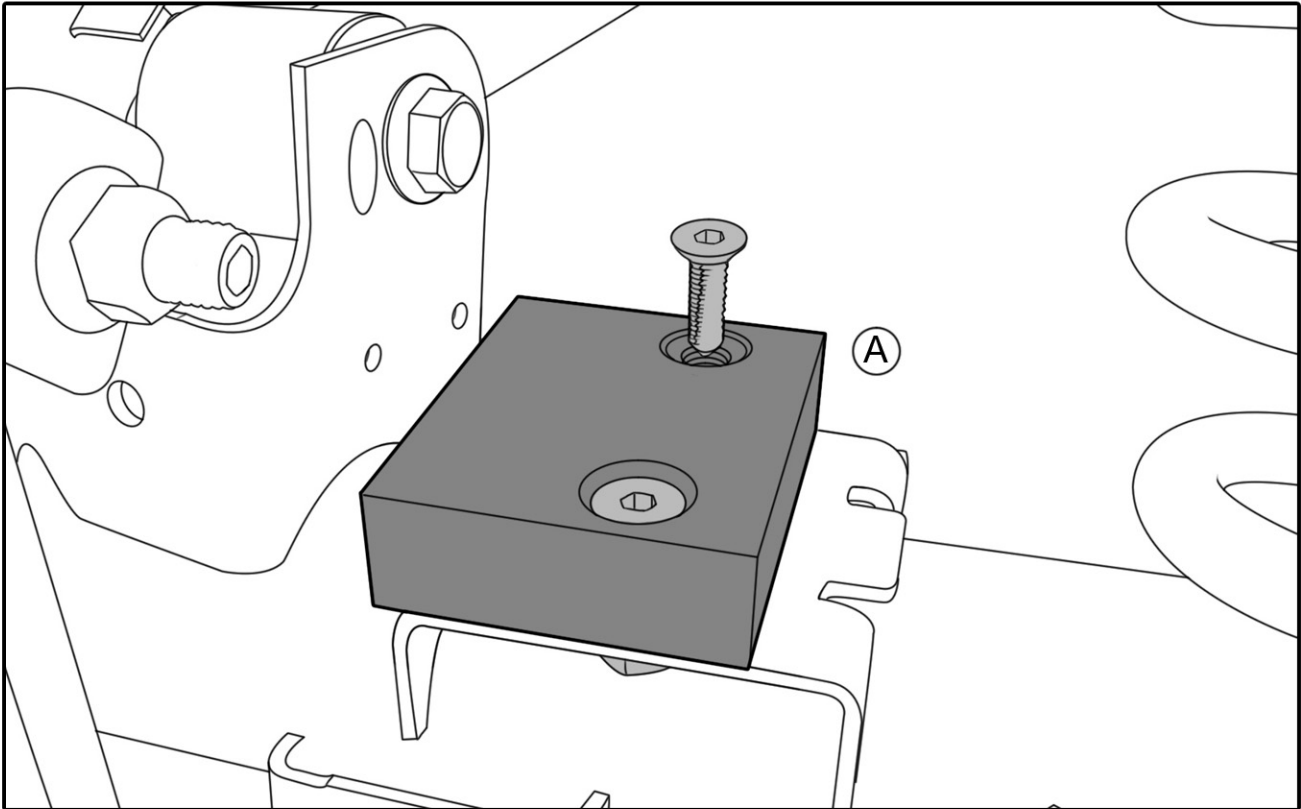

4. (A) Install new Bump Stop Spacers on axle using the supplied hardware.
(B) Install the supplied upper shock spacers, washers and bolts. Tighten to 37 ft lbs.

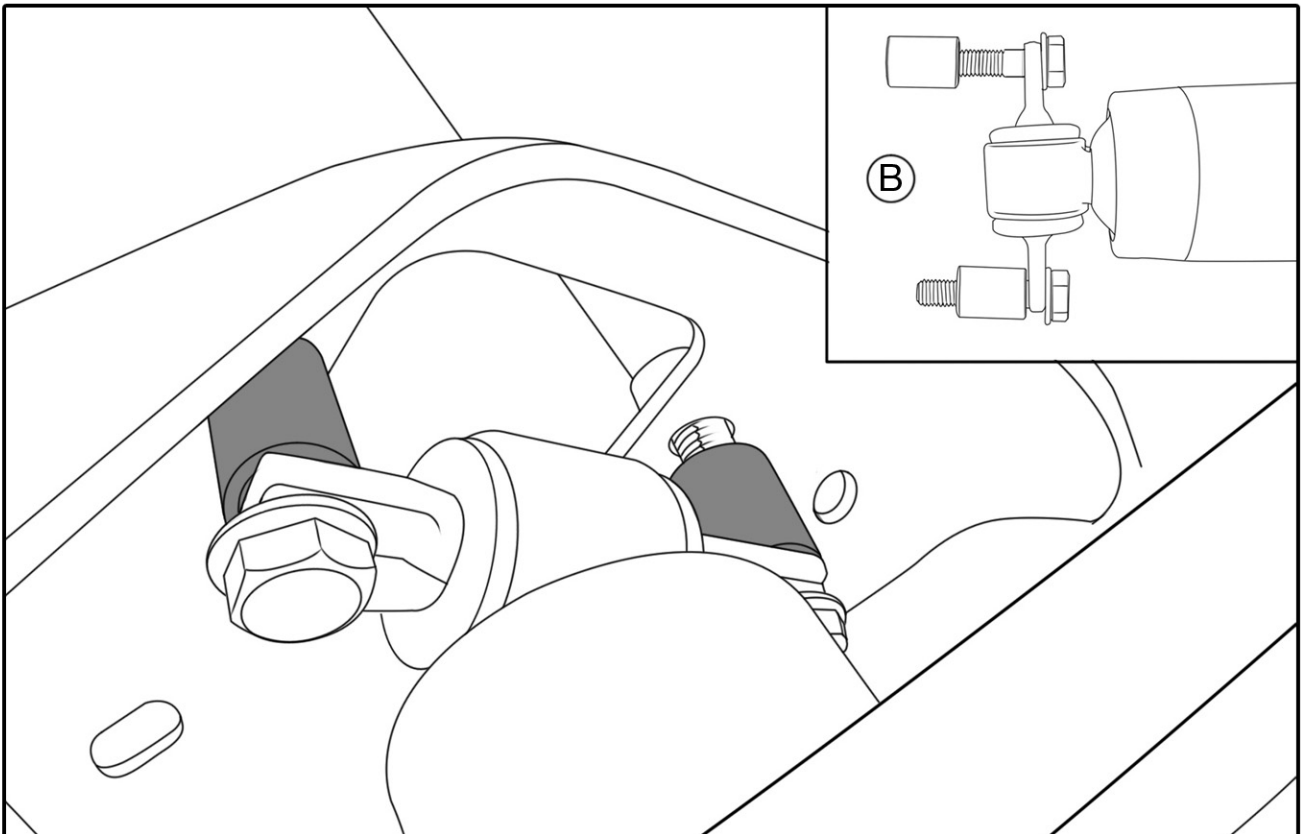

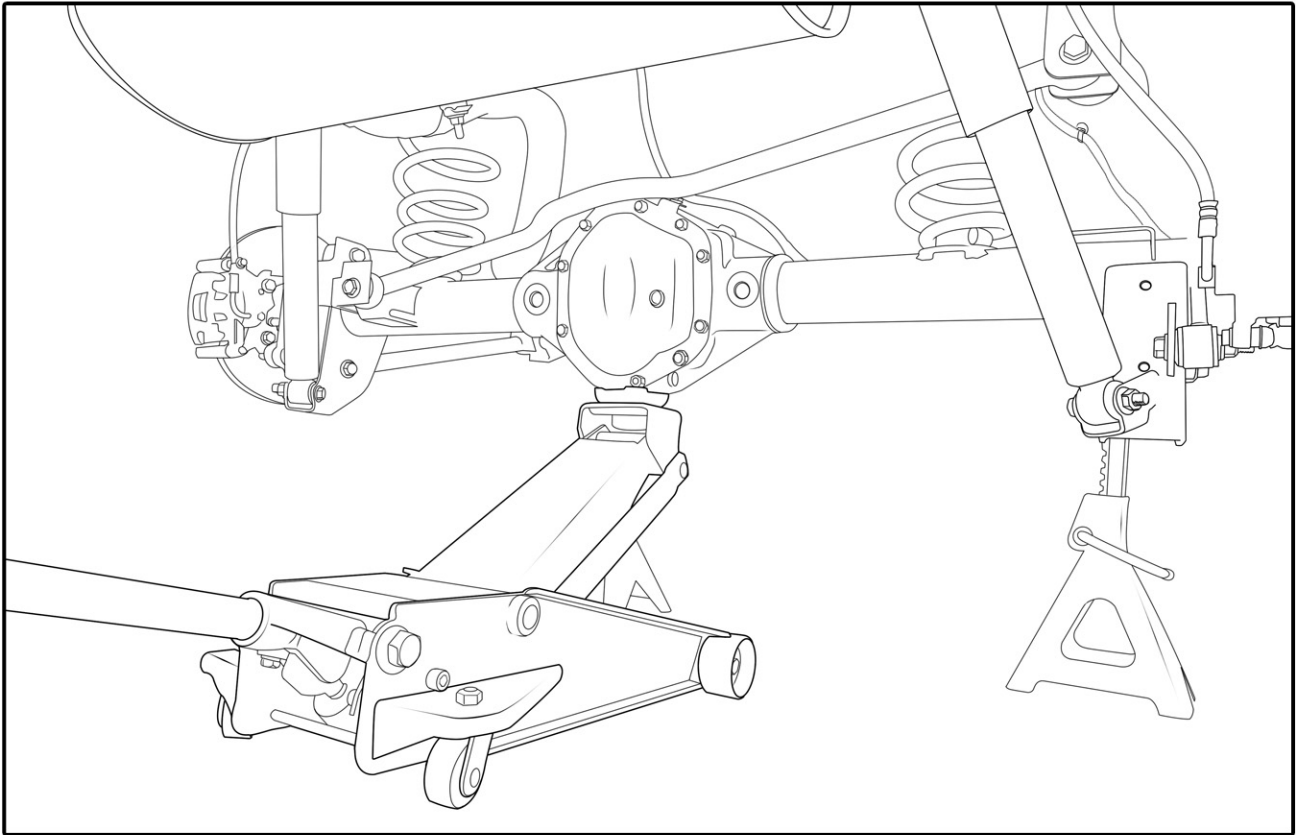

- 5.** - Raise axle slowly and guide springs into position.
- Reinstall lower sway bar link bolt. Tighten to 60 ft lbs. (Refer to step 2C.)
- Reinstall lower shock nut and bolt. Tighten to 56 ft lbs. (Refer to step 2B.)
- Reinstall brake line bolt. (Refer to step 2A.)
- Reinstall Wheels. Tighten to 105 ft lbs.

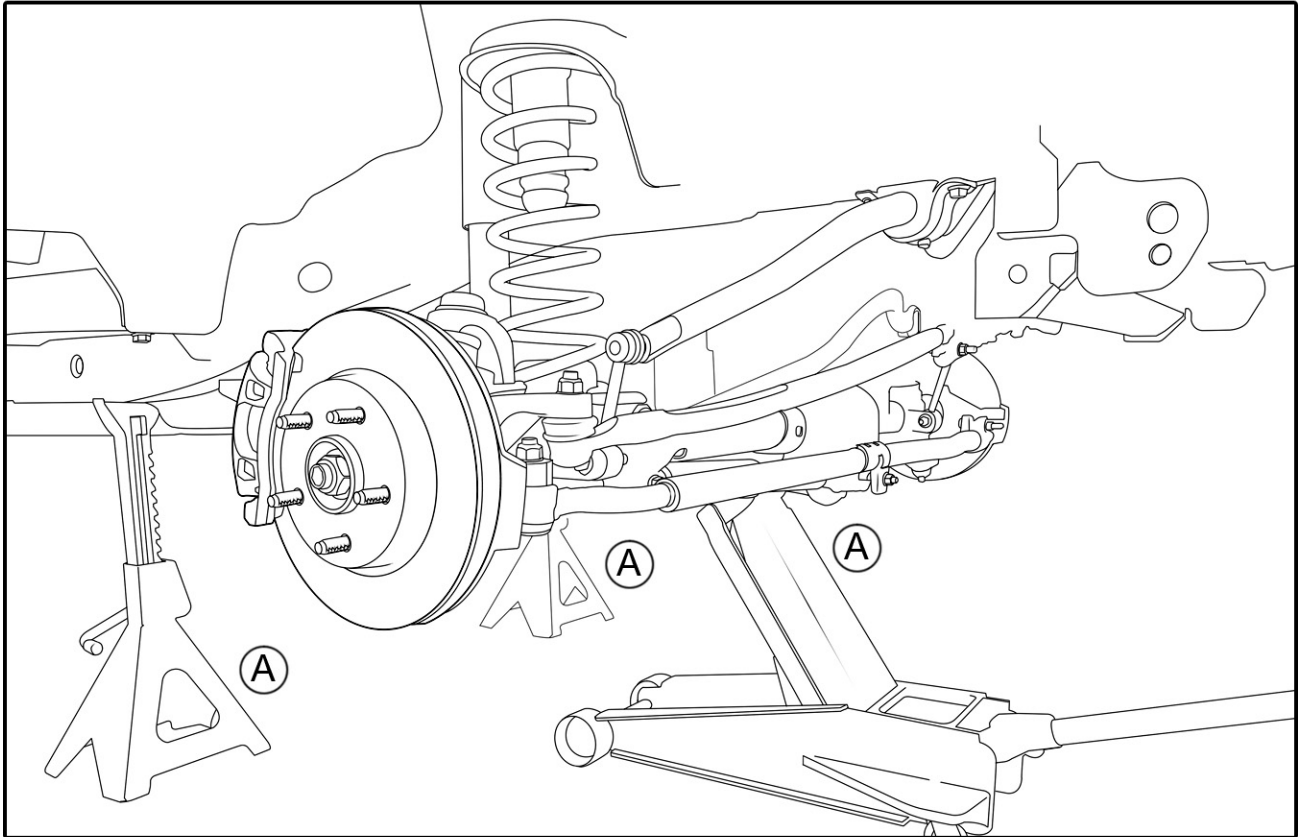

6. (A) Raise Jeep and support the frame using jack stands or a hoist such that the front axle can be lowered enough to remove the springs. Support the axle by placing a floor jack under the center of the axle. Remove the wheels.
- (B) Loosen but DO NOT remove all 8 control arm bolts.
- (C) Loosen but DO NOT remove the frame-side track bar bolt. Remove and save the axle side track bar bolt and flag nut.

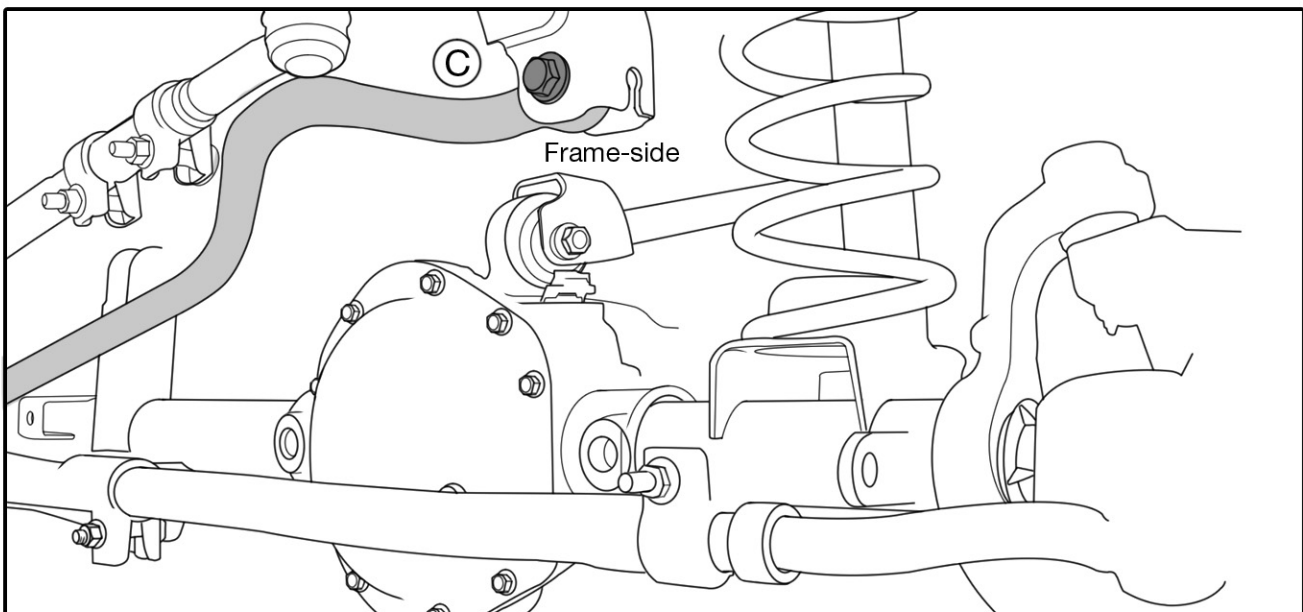

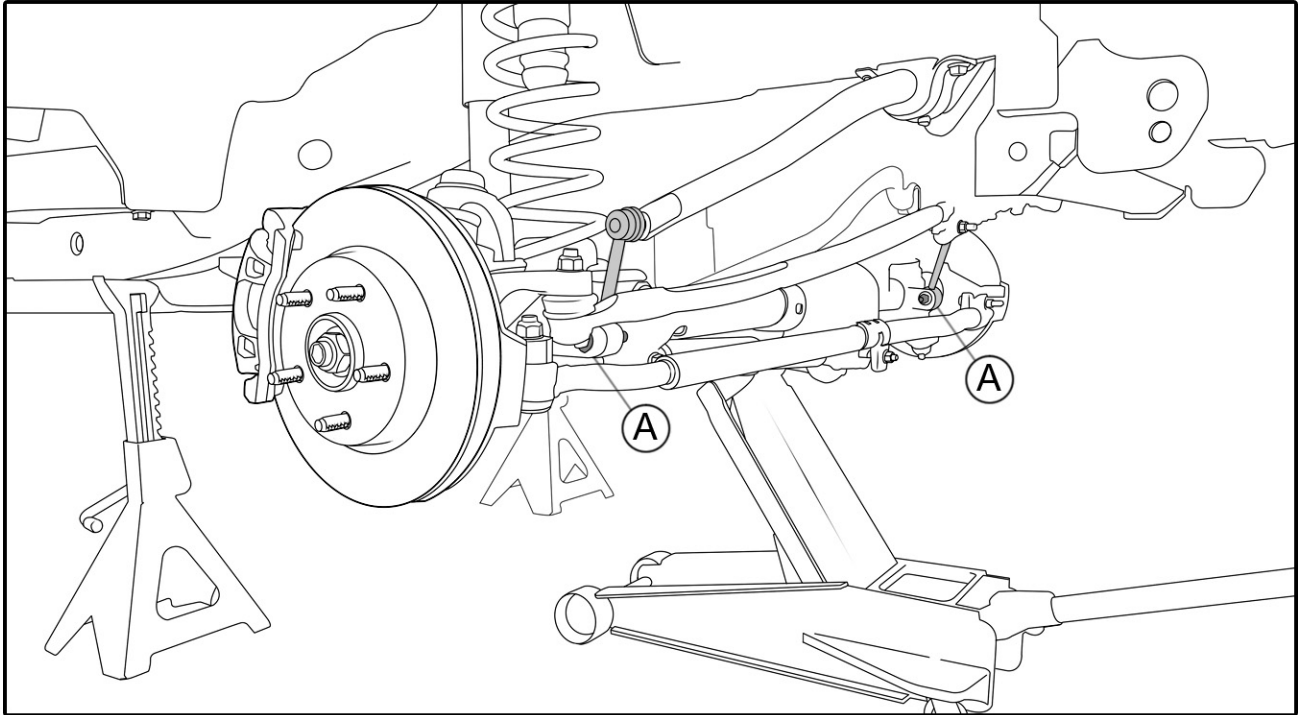

7. - On Rubicon models remove the push pins holding the wiring to the frame and upper control arm.
- (A) Remove and save all anti-sway bar link hardware.
 - (B) Remove and save all lower shock mounting hardware.
 - (C) Lower axle and remove springs. -DO NOT remove factory isolator.
 - (D) For 2011 and newer models, remove/discard factory bracket from the brake line.

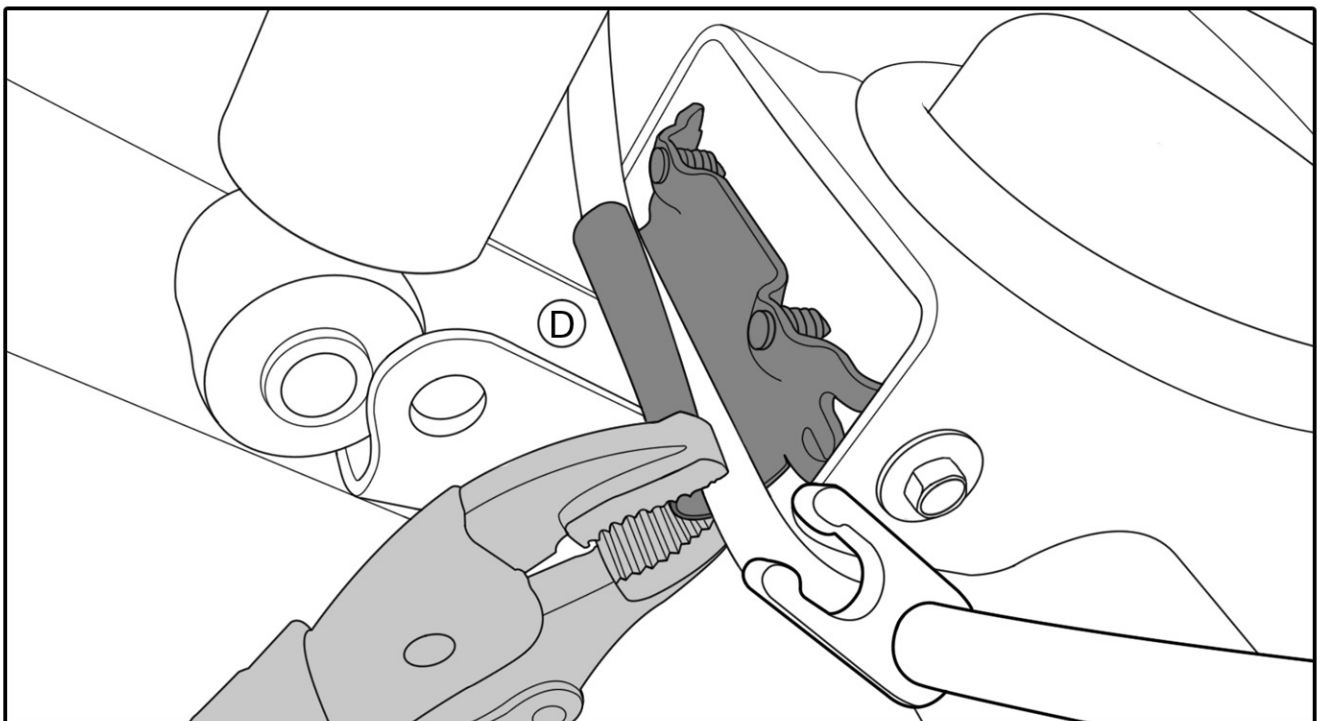

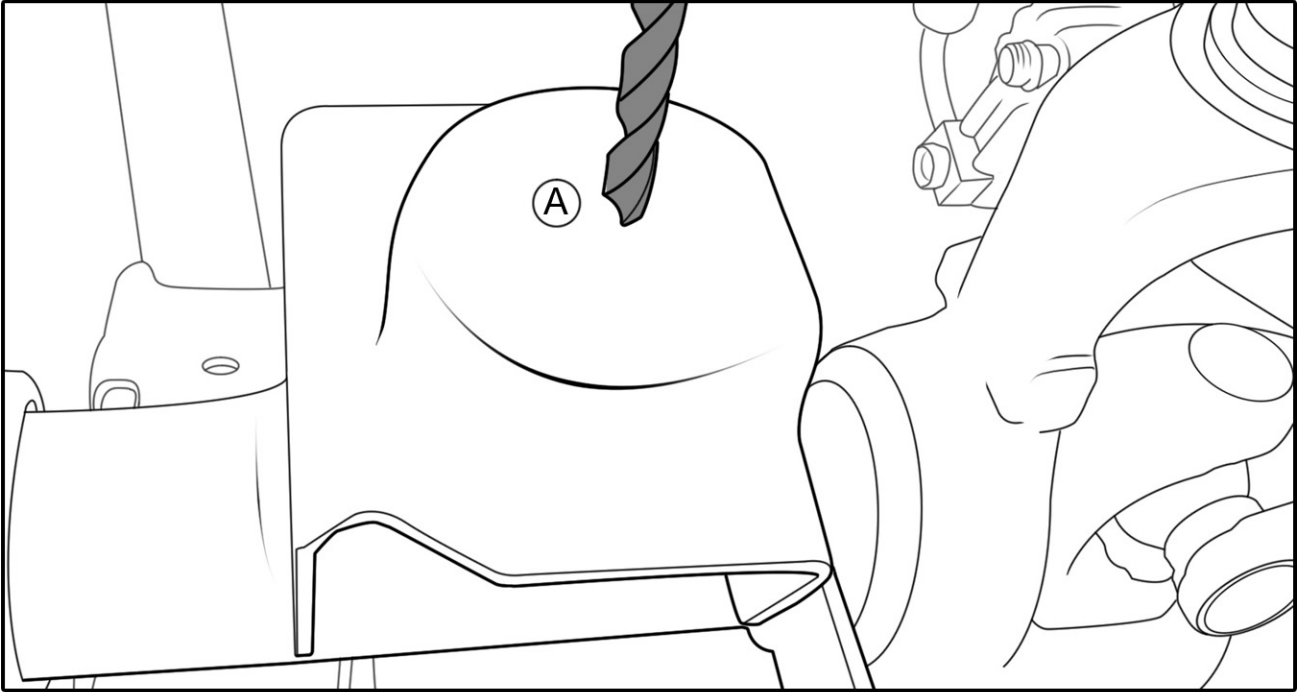

8. (A) Drill a 3/8 inch hole in the center of the axle bump stop pad.
(B) Install AEV spring spacer to upper spring seat, keeping the factory isolator in place.
(C) Place bump stop spacer inside factory spring and reinstall the spring. Make sure to index the spring correctly on the lower spring seat.
(D) Install and tighten bump stop spacer hardware.

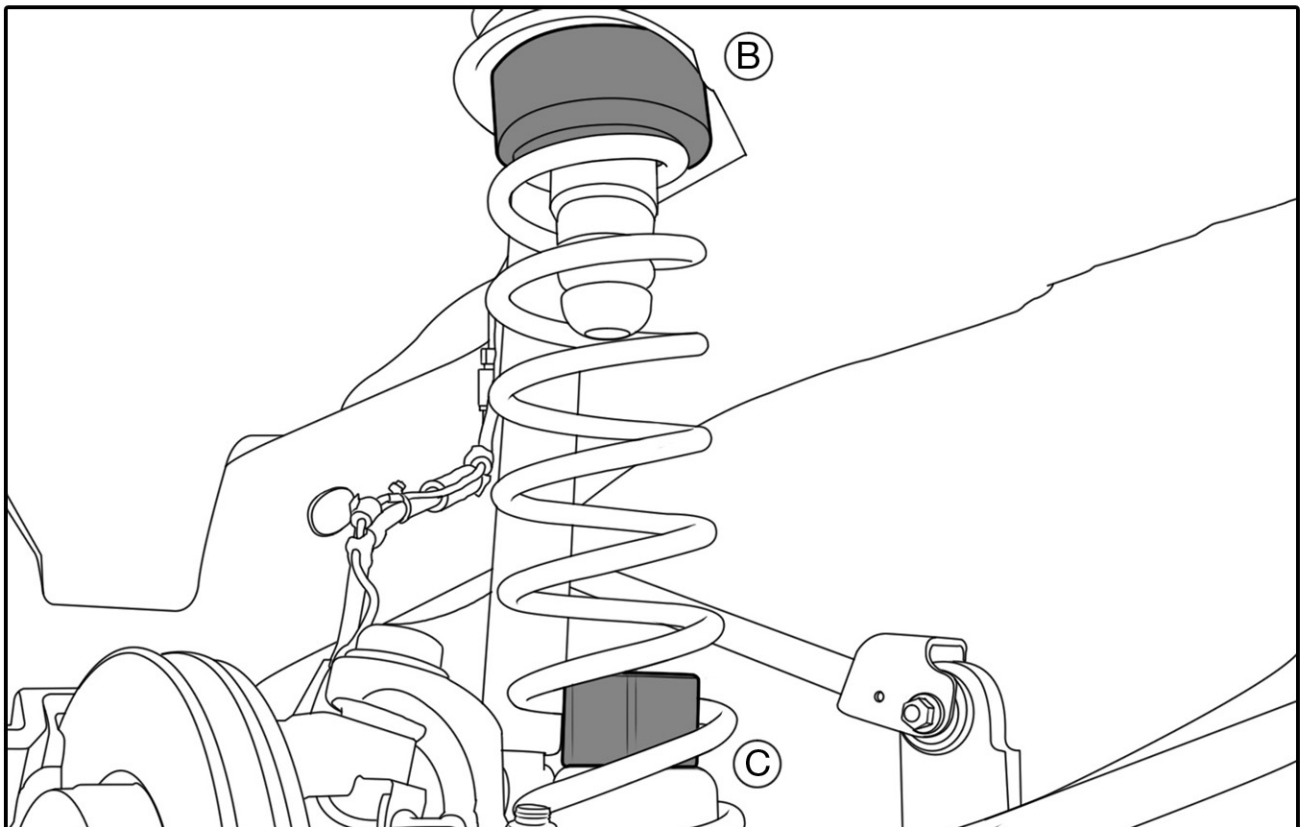

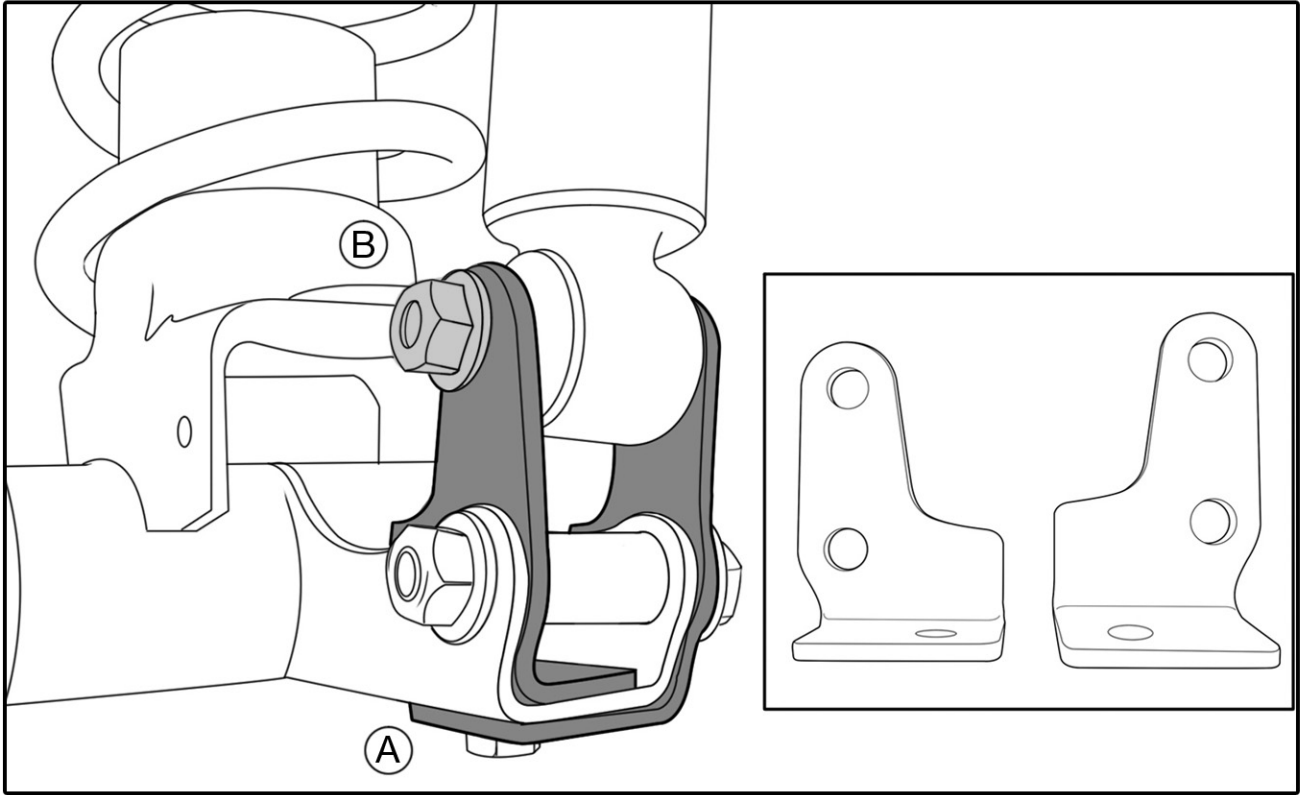

9. - Install new sway bar end links using factory hardware. (Refer to 7A.)
- (A) Install shock extension brackets as shown using supplied hardware.
 - (B) Reinstall factory lower shock hardware.
 - (C) For 2007-2010 model year JK's install the front brake line drop brackets.

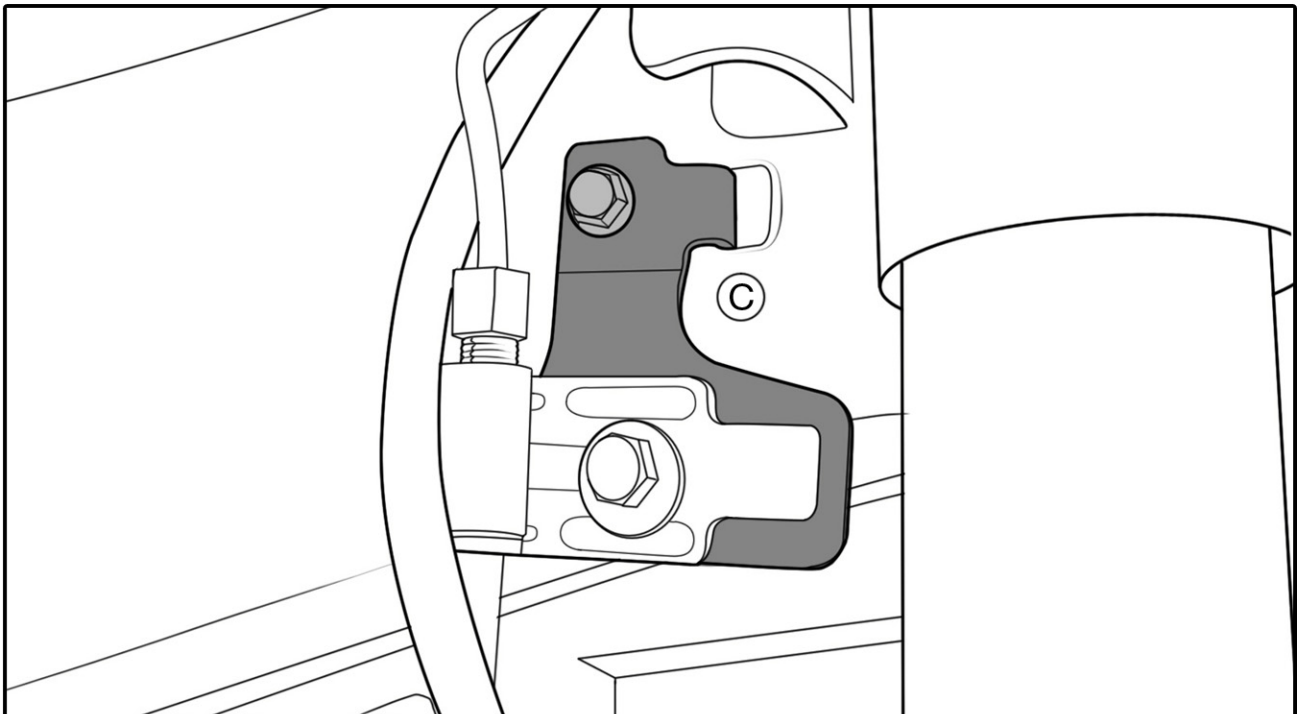

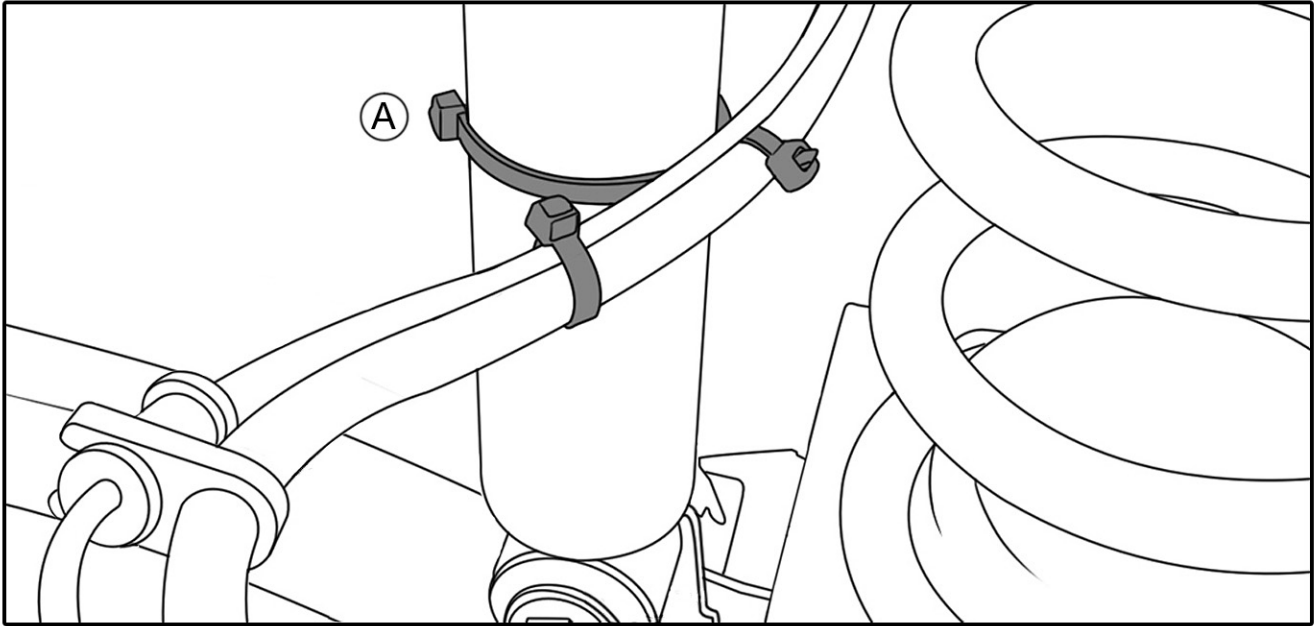

- 10.** (A) For 2011 and newer models, zip tie the brake line to the shock.
- (B) Reinstall wheels, place Jeep on level ground and tighten all fasteners to factory specs.

<p>Front - Upper control arm bushings: 75 ft lbs. - Lower control arm bushings: 125 ft lbs. - Track bar bushing frame: 96 ft lbs. - Track bar bushing axle: 111 ft lbs.</p> <p>Rear - Upper control arm bushings: 125 ft lbs. - Lower control arm bushings: 125 ft lbs.</p>
